

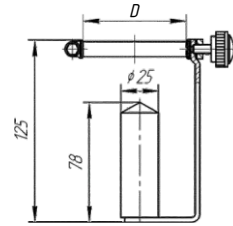

Rod Magnetic Separators S-1-1



Designed for refinement of liquid and dry materials from ferro magnetic impurities.

Installed at the place of free product outlet and is fixed on product pipeline with the help of a crow.

Name	D, mm	Magnetic induction*, mT, not less	Operation temperature, °C, not more	Weight, kg
S-1-1	20-32	500	80	0,37
S-1-1-01	25-40			0,38
S-1-1-02	32-50			0,39
S-1-1-03	20-32		150	0,37
S-1-1-04	25-40			0,38
S-1-1-05	32-50	0,39		
S-1-1-06	20-32	900	80	0,37
S-1-1-07	25-40			0,38
S-1-1-08	32-50			0,39

* Magnetic induction on magnetic block's surface occurs along the characteristic lines at the temperature 20 °C.

Rod Magnetic Separators S-1-3

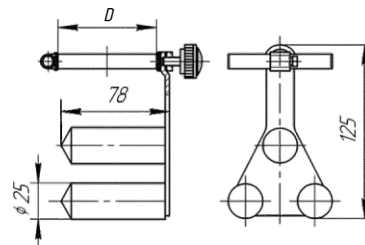

Designed for refinement of liquid and dry materials from ferro magnetic impurities.

Installed at the place of free product outlet and is fixed on product pipeline with the help of a crow.

Name	D, mm	Magnetic induction*, mT, not less	Operation temperature, °C, not more	Weight, kg
S-1-3	40-60	500	80	0,90
S-1-3-01	50-70			0,91
S-1-3-02	60-80			0,92
S-1-3-03	40-60		150	0,90
S-1-3-04	50-70			0,91
S-1-3-05	60-80	0,92		
S-1-3-06	40-60	900	80	0,90
S-1-3-07	50-70			0,91
S-1-3-08	60-80			0,92

* Magnetic induction on magnetic block's surface occurs along the characteristic lines at the temperature 20 °C.

