

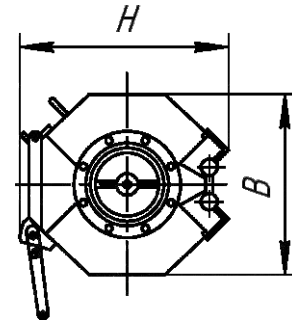

## Plate Piped Magnetic Separators PTSV

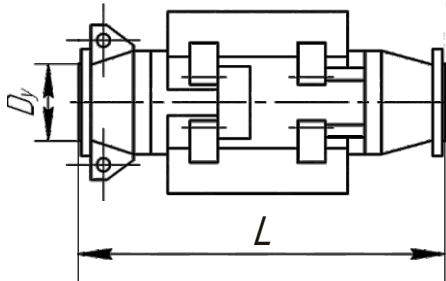

Designed for extracting ferro magnetic impurities from dry materials that are moved by pneumatic transport.

Installed on vertical pipelines of material supply.

Name	Arbitrary pipeline diameter $D_y$ , mm	Pipeline pressure, MPa, not more	Temperature of material °C, not more	Dimensions, mm			Weight, kg
				L	B	H	
PTSV-150	150	0.5	180	950	520	620	400
PTSV-200	200				570	650	500
PTSV-250	250				620	680	600
PTSV-300	300				680	720	700

1. Magnetic induction on magnetic blocks' surface occurs along the characteristic line according to technical specification.
2. Separator clean-up is conducted while the magnetic blocks are spread apart.

## Plate Piped Magnetic Separators PTMH

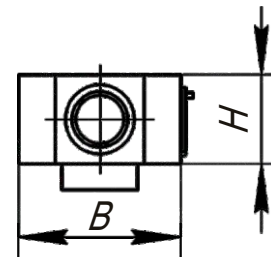
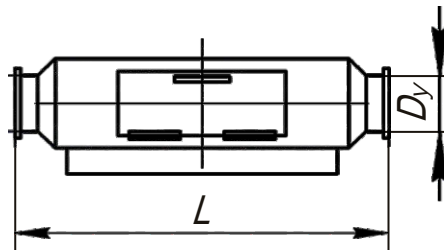

Designed for extracting ferro magnetic impurities from liquid materials that moved through a pipeline.

Installed on the horizontal pipelines of material supply.

Name	Arbitrary pipeline diameter, $D_y$ , mm	Pipeline pressure, MPa, not more	Productivity, $m^3/h$	Dimensions, mm			Weight, kg
				L	B	H	
PTMH-150	150	0.5	30	1050	600	550	350
PTMH-200	200		50		650	600	500
PTMH-250	250		80		700	750	650
PTMH-300	300		100		800	900	800

1. Magnetic induction on magnetic blocks' surface occurs along the characteristic line according to technical specification.
2. Manual separator clean-up, with an intermittence of product supply.

