

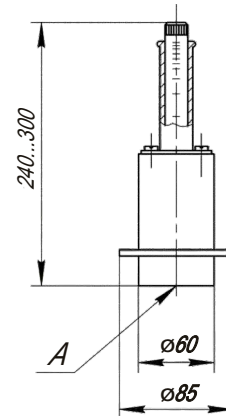

## Magnetic Analyser AMR



Designed for conducting high-quality express analysis of magnetic mineral flakes content in mineral raw material and for defining field characteristics, needed for carrying out magnetic separation of raw material.

<b>Magnet material</b>	<b>Nd - Fe - B</b>
<b>Magnetic induction along line A, adjustable, mT</b>	<b>10...900</b>
<b>Cleanup of magnetic block</b>	<b>mechanical</b>
<b>Overall dimensions, mm</b>	<b>85 x 240...300</b>
<b>Weight, kg, not more</b>	<b>2.0</b>

## Magnetic Manual Test Probe PMR

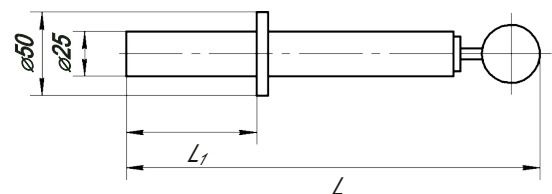

Designed for extracting ferro magnetic impurities from liquid and crumbling materials for further qualitative and quantitative analysis.

Name	Magnetic induction, mT	Maximum operation temperature, °C	Dimensions, mm		Weight, kg
			L	L <sub>1</sub>	
PMR	400	+80	330	110	0.65
PMR-01		+150			
PMR-02	600	+80	360	120	0.7
PMR-03		+150			

1. The value of magnetic induction is indicated on the surface of magnetic block along the characteristic lines at the temperature 20°C.
2. Mechanical cleanup.

