

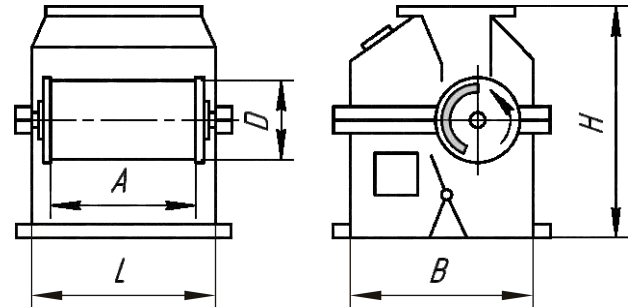

Drum Magnetic Separator BS



Designed for dry enrichment of ore and non-metallic materials, as well as for refinement of various non-magnetic materials from ferro magnetic impurities.

Applied at enterprises of ferrous metallurgy and other industries.

Name	Material	Dimensions, mm					Drive power, kW	Weight, kg, not more	
		D	A	B	L	H			
BS-50/50-N	Neodymium	500	500	1000	900	1100	2,2	600	
BS-50/65-N			650				1050	2,2	800
BS-50/100-N			1000				1400	3,0	1200
BS-63/65-N		630	650	1310	1060	1340	3,0	1400	
BS-63/80-N			800				1210	3,0	1600
BS-63/100-(N)	Ferrite (Neodymium)	630	1000	1310	1410	1340	3,0(4,0)	1950	
BS-63/150-(N)			1500				1910	4,0(5,5)	2400
BS-63/200-(N)			2000				2410	5,5(7,5)	2800
BS-80/100-(N)		800	1000	1500	1410	1500	3,0(4,0)	2400	
BS-80/150-(N)			1500				1910	4,0(5,5)	2800
BS-90/150-(N)		900	1500	1300	1800	1680	8,2	2800	
BS-120/200-(N)		1200	1975	2320	2300	2050	11,0	4500	

- (N) - magnetic system from neodymium magnets.
- Magnetic induction on drum surface is according to technical specification:
80 - 150 mT for ferrite magnetic systems;
200 - 800 mT for neodymium magnetic systems.
- Separator's productivity is defined for concrete materials after filling in a questionnaire or carrying out trial magnetic separation.
- Manufacturing of separators accounting for customer's requirements is available.

